

Telephone wall instrument OB 92

Part no.: 60260

Product description:

- electronic speaking connection
- ringing current generation through hand inductor
- with outgoing call signal: listen-in can be switched off
- battery - state indicator
- battery compartments accessible without tools
- (by pressing down on the transparent cover at the top of the housing and pushing it in the direction of the arrow)
- connection to TAE socket (plug connection)
- connection cable 3m (selectable 1m) can be plugged into the device
- selectable connection possibilities of the handset cable
- at the left side of the device
- at the back of the device
- Energy supply selectable:
 - battery supply
 - external supply
- grip recess for carrying the instrument
- screwed connection with wall console (Part no.: 61200)
- Housing: ABS impact resistant, antistatic
- slipproof rubber feet
- Colour: old white
- Delivery condition:
 - with dynamic hearing and speaking capsule
 - without battery: 2 off mono cell are required

Application example:

- telephone instrument in the telecommunication boxes
- terminals in local battery operation

Main dimensions:

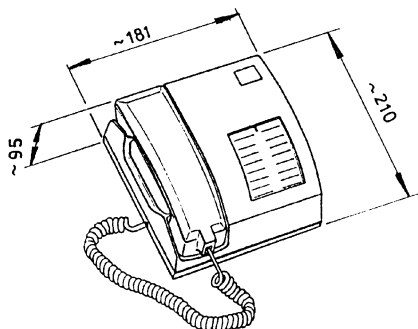

Mounting mass:

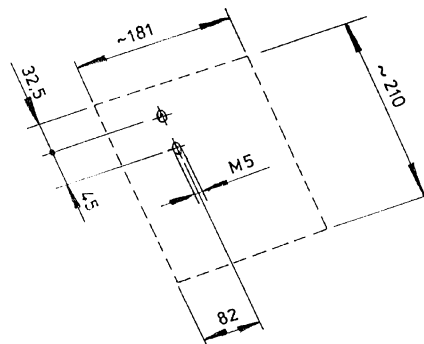

Subject to alterations.

OB 92

Connecting allocation

Connecting scheme

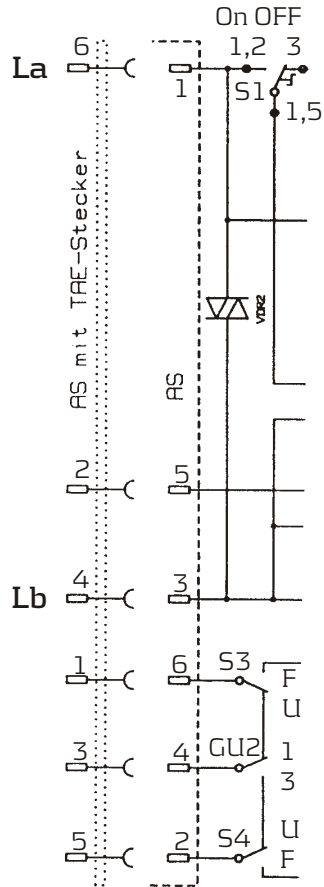

View onto printed circuit board

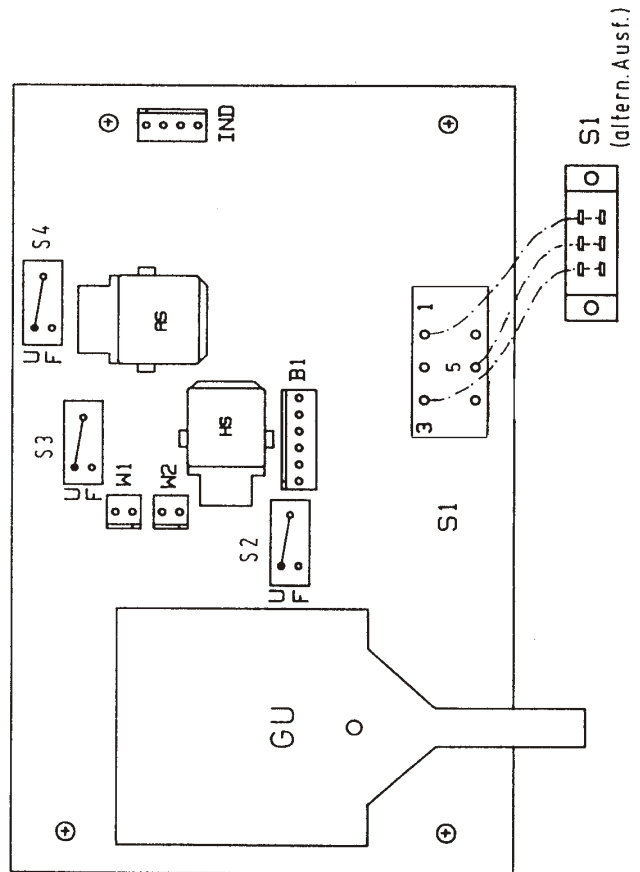

Für normalen Betrieb wird nur Anschluss La und Lb benötigt, d.h. der OB 92 wird 2-polig an das Ortsbatterie-Fernsprechnet (oder den nächsten OB 92 angeschlossen)

Alle anderen Anschlüsse werden für spezielle Anwendungen des Bahnbetriebes benötigt.

GU - replaced marked switch S2 - S4
 F = external supply
 U = changeover contact (delivery condition)

CAUTION: with external supply, the cells in the battery compartment must be removed!

Please note with external supply: the working area here lies between 4 Volt and 30 Volt direct current!

Changeover switch

S2, S3, S4 = switching position F = external supply
 switching position U = changeover contact
 (delivery condition: switch position U)

B1 = connection battery state indicator

IND = hand inductor

AS = connecting cable, 6-wire

HS = handset cable

GU = cradle switch (8-wire)

S1 = changeover switch for outgoing call signal (listening-in)
 (also accessible on the under side of the floor pan)