

# Telephone instrument OB 92

## product description:

- electronic speaking connection
- ringing current generation through hand inductor
- with outgoing call signal: listen-in can be switched off
- battery-state indicator
- battery compartments accessible without tools  
(by pressing down on the transparent cover at the top of the housing and pushing it in the direction of the arrow)
- connection to TAE socket (plug connection)
- connection cable (selectable 1m/3m/5m/DIN6) can be plugged into the device
- selectable connection possibilities of the handset cable
  - at the left side of the device
  - at the back of the device
- grip recess for carrying the instrument
- screwed connection with wall console (part no.: 61200)
- housing: ABS impact resistant, antistatic
- slipproof rubber feet
- with dynamic hearing and speaking capsule
- colour: old white
- delivery condition without battery: two pieces of D cell (LR20/mono cell) are required

## application example:

- telephone instrument in the telecommunication boxes
- terminals in local battery operation

## main dimensions:

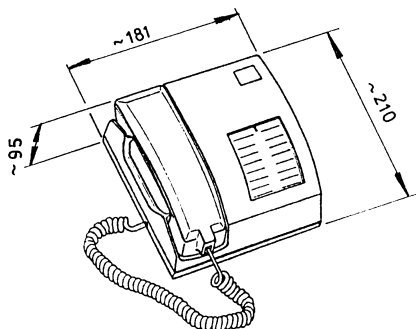

## mounting mass:

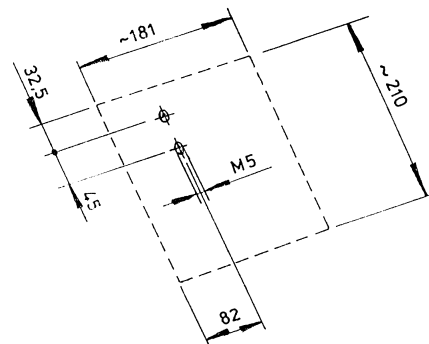

subject to alterations.

# OB 92

## Connecting allocation

Connecting scheme

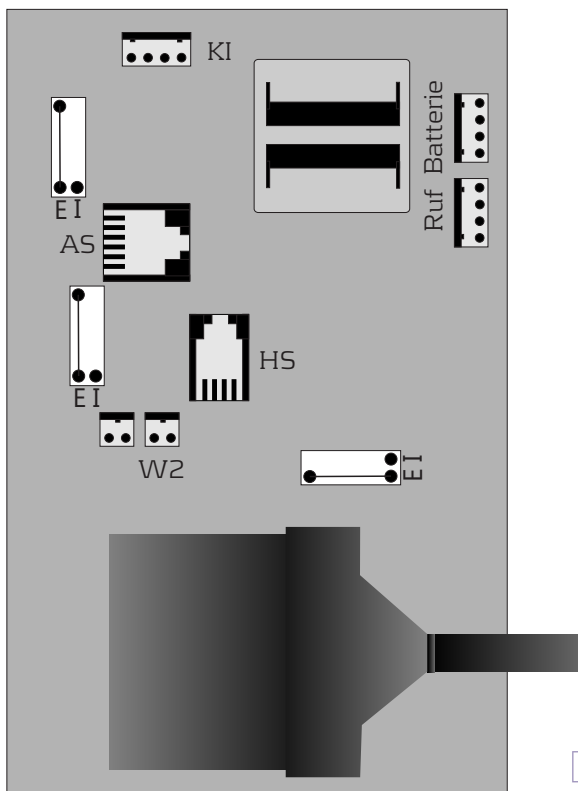
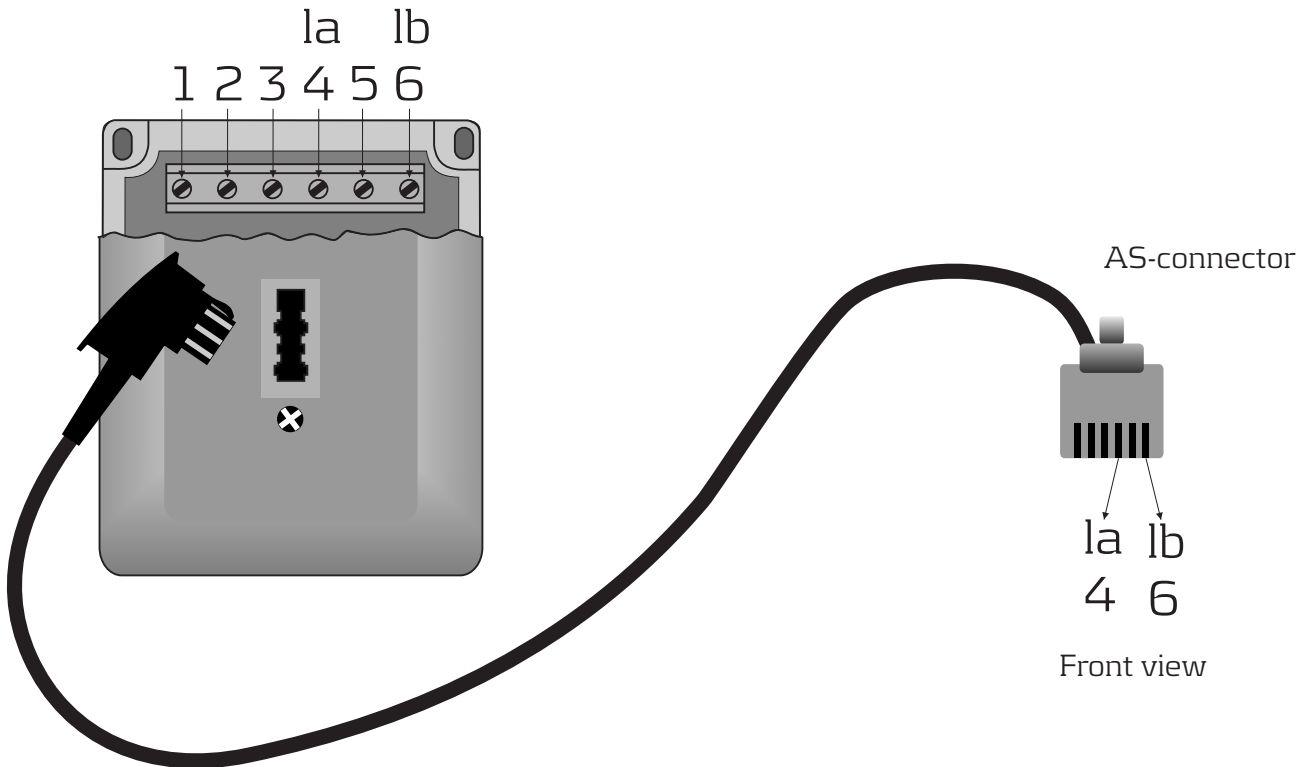

W2 = Bell

Batterie = connection batterie state indicator

KI = hand inductor

AS = connecting cable, 6-wire

HS = handset cable, 4-wire

Ruf = changeover switch for outgoing call signal (listening-in)  
(also accessible on the under side of the floor pan)

E = Position External power supply

I = Position Internal power supply